

THE CITY OF AUDUBON hopes the following information will be useful to you:

EMERGENCY	911
FIRE	712-563-2500
POLICE	712-563-2500
CITY CLERK	712-563-3269
PUBLIC WORKS/ZONING	712-563-2757 / cell 712-304-2512

PETS — The City has a leash law which applies to both dogs and cats. Please keep them leashed or kenneled.

WINTER WEATHER — City law requires that each resident keep sidewalks free of snow and ice.

SUMMER WEATHER —City law requires that you keep your yard mowed and trimmed. Trees need to be kept trimmed so they are at least 8 feet above the sidewalk and 15 feet above the street.

JUNK VEHICLES — Junk vehicles are not allowed within the City limits.

GARBAGE/RECYCLING PICKUP- Garbage and Recycling will be picked up once each week. Garbage in the alley where an alley is available. Recycling pick up will be curb or street side. **(SEE ENCLOSED MAP FOR PICKUP DAYS)** East Division Street and East will be picked up Tuesday. west of East Division Street will be picked up Wednesday. Start time is 7:00 a.m. The hauler will not pick up yard waste, or other excluded items. **CONTAINERS:** transparent, semi-transparent or white garbage bags or cans no larger than 33 gallons or weighing no more than 40lbs. Recycling in approved green plastic bins. Set container out by your garbage.

THE APPROVED CONTAINERS, IF NOT LEFT AT THE HOUSE, CAN BE PICKED UP AT THE AUDUBON COUNTY TRANSFER STATION, 1881 215th ST. PHONE 712-563-3589. THERE MAY BE A DEPOSIT.

IF you ARE UNABLE TO GET YOUR GARBAGE/RECYCLING TO THE ALLEY OR CURB YOU MAY CONTACT THE HAULER TO MAKE SPECIAL ARRANGEMENTS AT NO EXTRA CHARGE. we contract with Bohlmann & son's sanitation. Rick & Tauna Bohlmann. 712-563-2006; 712-304-1934.

NOT ALLOWED IN GARBAGE: Dog/cat waste, Engine Oil Filters, Anti-freeze, Liquid Paint, Engine Oil.

GARBAGE CHARGE- A charge for garbage pickup in the amount of \$18.00/month is added to your utility bill. Landfill/Transfer Station hours are 8:00 AM — 4:00 PM, Monday — Friday. Every Saturday in summer & the first Saturday of the month in winter. 8:00 AM — NOON. Rates vary according to load, weight, and content. Call the Audubon County Sanitary Landfill/Transfer Station 712-563-3589 for more information.

BUILDING PERMITS — Building permits are required for any remodeling or new construction. Applications are available at City Machine Shop. Please call 712-563-2757/304-2512

COMMUNITY BUILDING- The Memorial building is available for rent. To make a reservation, call City Hall at 563-3269.

UTILITY SERVICES - Services available in Audubon are:		
Electric & Gas	MidAmerican Energy	888-427-5632
Telephone/Internet	Mediacom	855-633-4226
Cable TV	Mediacom	855-633-4226
Telephone/Internet	Windstream	877-901-4692
Water Utility	City Hall	712-563-3269

CITY OF AUDUBON BILLING INFORMATION

WATER BILL: based on gallons used. The current rates set in July, 2010 are:

-	5000 gallons	\$18.25 minimum (\$3.65 per 1000 gallons)
5001 -	30000 gallons	\$4.00 per 1000 gallons
Over 30000	gallons	\$3.00 per 1000 gallons

The gallons are measured by a water meter. Your meter will be read quarterly and you will be billed quarterly. When your billed is determined by your account number.

***The last 3 numbers of your account number may vary, but the first 2 to 5 numbers indicate your account location.**

If your **Account No. is between 10001 — 5410001**, you are in cycle I-Meters are read in months of January, April, July & Oct. & your bills are due in February, May, August & November.

If your **Account No. is between 9150001 — 12880001** you are in cycle 2-Meters are read in months of February, May, August & November & your bills are due in March, June, September & December.

If your **Account No. is between 5430001 — 9140001** you are in cycle 3-Meters are read in March, June, September & December and your bills are due in April, July, October & January.

WATER, TAX, SEWER, GARBAGE/RECYCLING are billed to you by the City of Audubon.

YOU CAN MAKE MONTHLY PAYMENTS TOWARD BILL, JUST PAY THE BALANCE WHEN DUE.

SEWER RATE: based on water usage. The current rate was set in March, 2017.

-	5000 gallons	\$57.52 minimum (\$11.504 per 1000)
Over 5000	gallons	\$14.92 per 1000 gallons

WHEN BILLS ARE DUE: Normally the last working day of the month. If the total due is not received on the due date a 5% penalty will be added. A reminder notice will be mailed on the first working day, following the due date, giving you twelve (12) days to pay, or request a hearing. If renting, your landlord will be sent a copy of this notice. If the total due is not paid, and no request for a hearing is received in a timely manner, as addressed on the notice, your services will be discontinued and subject to an additional \$100.00 in service fees. The total MUST be paid before your services will be re-connected.

DROP BOX FOR A PAYMENT IS LOCATED INSIDE THE MEMORIAL BUILDING ON THE COUNCIL ROOM DOOR. If the check or money order has the name the service account is in you do not need an envelope. DO NOT PUT CASH IN THE DROP BOX! **DO NOT PUT CASH IN THE DROP BOX!**

IF YOU HAVE ANY QUESTIONS CALL THE CITY CLERK'S OFFICE AT 712-563-3269.

AUDUBON

West of East Division Street
Wednesday
Garbage & Recycling
Pickup

East Division Street &
east
Tuesday
Garbage & Recycling
Pickup.

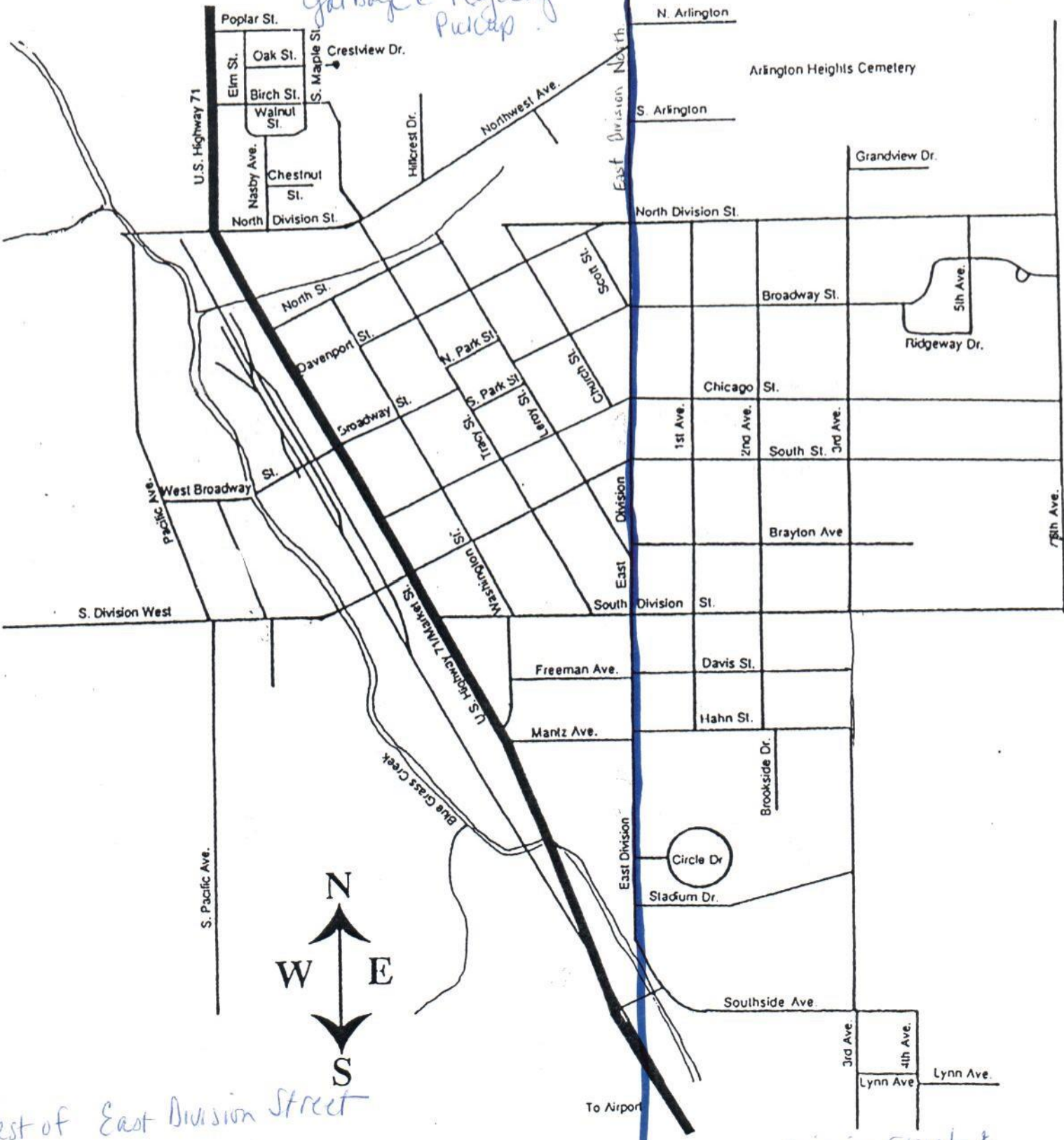

West of East Division Street
Wednesday
Garbage & Recycling
Pickup

East Division Street &
east
Tuesday
Garbage & Recycling
Pickup

410 N PARK PL
AUDUBON IA 50025
712-563-3269

RECYCLING GUIDE

It is important that every resident in the area recycle the right way. Empty and rinse containers and please don't mix paper products with your other recyclable containers. Cans and plastic may be mixed together in the same bag. All recycling **MUST** be completely separated into three groups, this will comply with Audubon County Transfer Station Rules.

Group 1 Recyclable Paper products- Newspapers (including all inserts), phone books, junk mail, magazines, catalogs, office paper, and boxboard containers (cereal boxes, gift boxes, shoe boxes)

- Remove all plastic liners and paper from cardboard containers and flatten boxes
- All the above paper products may be mixed and MUST be bagged or bundled
- Place bagged or bundled paper products on top of or beside your recycling bin.
- DO NOT place paper products loose in your recycling bin or mix with your cans or plastic containers.

NOT RECYCLABLE

Hardcover books, fax paper, wax paper, tissue paper, wood products, gift wrap paper, milk cartons, or paper bags with wax coating that cannot be removed, and kitty litter.

Group 2 Recyclable co-mingles-All aluminum cans, containers, tin food and beverage cans (juice cans, canned fruit and vegetable cans) All clear and colored plastic containers and bottles (milk jugs, soft drink and juice bottles, detergent and bleach bottles, yogurt containers and ketchup bottles)

- Empty and rinse cans. Labels are okay
- Empty, rinse and flatten jugs.
- Throw away lids

NOT RECYCLABLE

Glass containers (not accepted at transfer station) Furniture, furnace filters, metal pots and pans, kitchen appliances, and aluminum siding. Plastic bags, Styrofoam products (egg cartons, take out or packing peanuts), toys, flower pots, waste baskets, laundry baskets or Tupperware type products.

Group 3 Recyclable corrugated cardboard-the type of card board with two layers of paper surrounding an inner layer of fluted/wavy paper.

- Remove all contents and flatten boxes
- Place cardboard bundle beside or underneath your recycling bin

NOT RECYCLABLE

Wax cardboard, milk cartons, pizza boxes and dirty cardboard boxes.

THANK YOU FOR YOUR COOPERATION.